

Standardverschraubungen

Messing vernickelt
Artikel-Nr. 251.00/N bis 236.04-N

P 6-337

Für Luft, Wasser, Öl, Dampf etc.

Betriebstemperatur: max. 150 °C
max. 80 °C (mit NBR-O-Ring)

Druck: max. 60 bar

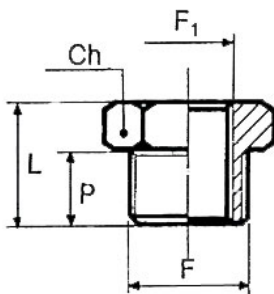

251.02/N

Reduziernippel

Artikel-Nr.	Außen- gewinde F	Innen- gewinde F1	Ch mm	P mm	L mm
251.00/N	G 1/8	M5	14	6,0	10,5
251.01/N	G 1/4	G 1/8	17	8,0	13,0
251.06/N	G 3/8	G 1/8	20	9,0	14,0
251.02/N	G 3/8	G 1/4	20	9,0	14,0
251.08/N	G 1/2	G 1/8	24	10,0	15,5
251.07/N	G 1/2	G 1/4	25	10,0	15,5
251.03/N	G 1/2	G 3/8	25	10,0	15,5
251.09/N	G 3/4	G 3/8	30	11,0	17,5
251.10/N	G 3/4	G 1/2	30	11,0	17,5
251.11/N	G 1	G 1/2	36	12,0	19,0
251.12/N	G 1	G 3/4	36	11,5	19,0

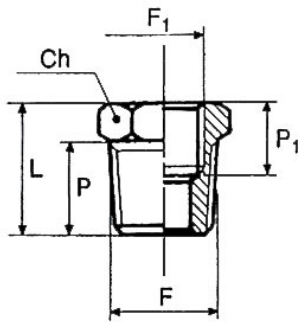

235.04/N

Reduziernippel, Außengewinde konisch, Innengewinde zylindrisch

Artikel-Nr.	Außengewinde F	Innengewinde F1	Ch mm	P mm	P1 mm	L mm
235.01/N	R 1/4	G 1/8	14	11,0	7,0	16,0
235.02/N	R 3/8	G 1/8	17	11,5	7,0	17,0
235.03/N	R 3/8	G 1/4	17	11,5	8,0	17,0
235.04/N	R 1/2	G 1/8	22	14,0	8,0	19,5
235.05/N	R 1/2	G 1/4	22	14,0	8,0	20,0
235.06/N	R 1/2	G 3/8	22	14,0	10,0	20,0
235.07/N	R 3/4	G 3/8	27	16,5	11,5	23,0
235.08/N	R 3/4	G 1/2	27	16,5	14,0	23,0
235.09/N	R 1	G 1/2	34	16,0	15,0	25,0
235.10/N	R 1	G 3/4	34	18,0	15,0	25,0

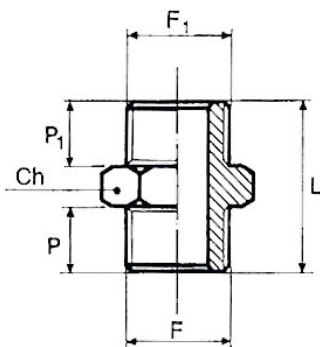

252.62

Doppelgewindenippel, Außengewinde zylindrisch

Artikel-Nr.	Gewinde 1 F	Gewinde 2 F1	Ch mm	P mm	P1 mm	L mm
252.31	M5	M5	8	4,0	4,0	11,5
252.32	M5	G 1/8	14	4,0	6,0	14,5
252.33	G 1/8	G 1/8	14	6,0	6,0	17,0
252.34	G 1/8	G 1/4	17	6,0	8,0	19,0
252.35	G 1/8	G 3/8	20	6,0	9,0	20,0
252.61	G 1/4	G 1/4	17	8,0	8,0	21,0
252.62	G 1/4	G 3/8	20	8,0	9,0	22,0
252.63	G 1/4	G 1/2	25	8,0	10,0	24,0
252.64	G 3/8	G 3/8	20	9,0	9,0	24,0
252.65	G 3/8	G 1/2	25	9,0	10,0	25,5
252.66	G 1/2	G 1/2	25	10,0	10,0	26,5
252.67	G 1/2	G 3/4	30	10,0	11,0	27,5
252.68	G 3/4	G 1	36	12,0	11,0	30,0
252.69	G 3/4	G 3/4	30	11,0	11,0	28,0
252.70	G 1	G 1	36	12,0	12,0	31,0

Standardverschraubungen

Messing vernickelt
Artikel-Nr. 251.00/N bis 236.04-N

P 6-337

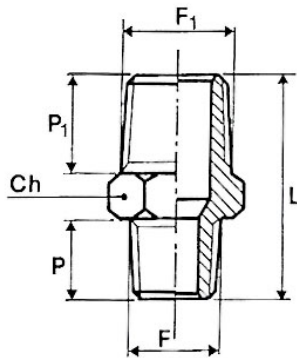

1252.66

Doppelgewindenippel, Außengewinde konisch

Artikel-Nr.	Gewinde 1 F	Gewinde 2 F1	Ch mm	P mm	P1 mm	L mm
1252.33	R 1/8	R 1/8	12	8,0	8,0	21,0
1252.34	R 1/8	R 1/4	14	8,0	11,0	24,0
1252.35	R 1/8	R 3/8	17	8,0	11,5	25,0
1252.61	R 1/4	R 1/4	14	11,0	11,0	27,0
1252.62	R 1/4	R 3/8	17	11,0	11,5	28,0
1252.63	R 1/4	R 1/2	22	11,0	14,0	32,0
1252.64	R 3/8	R 3/8	17	11,5	11,5	29,0
1252.65	R 3/8	R 1/2	22	11,5	14,0	32,5
1252.66	R 1/2	R 1/2	22	14,0	14,0	35,0
1252.67	R 1/2	R 3/4	27	14,0	16,5	37,0
1252.69	R 3/4	R 3/4	27	16,5	16,5	40,0
1252.68	R 3/4	R 1	34	16,5	19,0	42,5
1252.70	R 1	R 1	34	19,0	19,0	45,5

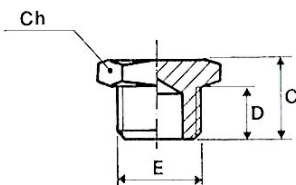

252.96/N

Verschlusschrauben, Außengewinde zylindrisch

Artikel-Nr.	Gewinde E	C mm	D mm	Ch mm
252.90/N	M5	7,0	4,0	8
252.95/N	G 1/8	10,0	6,0	14
252.96/N	G 1/4	12,5	8,0	17
252.97/N	G 3/8	13,5	9,0	19
252.98/N	G 1/2	15,5	10,0	24
252.99/N	G 3/4	16,5	11,0	30
252.100/N	G 1	19,0	13,0	38

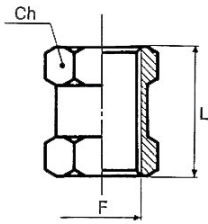

252.23/N

Muffen

Artikel-Nr.	Gewinde F	Ch mm	L mm
252.20/N	M5	8	11,0
252.21/N	G 1/8	14	15,0
252.22/N	G 1/4	17	22,0
252.23/N	G 3/8	22	24,0
252.24/N	G 1/2	27	30,0
252.24/1-N	G 3/4	32	32,0
252.25/N	G 1	38	35,0

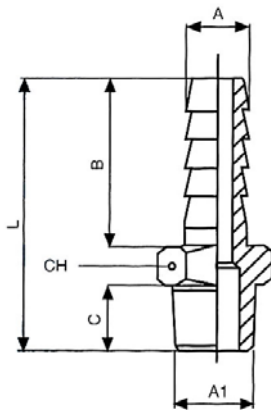

239.107

Einschraub Schlauchtüllen, Außengewinde konisch nach ISO 7-1

Artikel-Nr.	A mm	Gewinde A1	B mm	C mm	L mm	CH mm
239.101	LW 6	R 1/8	19,0	8,0	31,5	12
239.102	LW 8	R 1/8	19,0	8,0	31,5	12
239.103	LW 9	R 1/8	19,0	8,0	31,5	12
239.104	LW 10	R 1/8	20,0	8,0	32,5	12
239.105	LW 6	R 1/4	19,0	11,0	35,0	14
239.106	LW 8	R 1/4	19,0	11,0	35,0	14
239.107	LW 9	R 1/4	19,0	11,0	35,0	14
239.108	LW 10	R 1/4	20,0	11,0	36,0	14
239.109	LW 12	R 1/4	20,0	11,0	36,0	14
239.110	LW 9	R 3/8	19,0	11,5	35,5	17
239.111	LW 10	R 3/8	20,0	11,5	36,5	17
239.112	LW 12	R 3/8	20,0	11,5	36,5	17
239.113	LW 9	R 1/2	19,0	14,0	38,5	22
239.114	LW 10	R 1/2	20,0	14,0	39,5	22
239.115	LW 12	R 1/2	20,0	14,0	39,5	22

Standardverschraubungen

Messing vernickelt
Artikel-Nr. 251.00/N bis 236.04-N

P 6-337

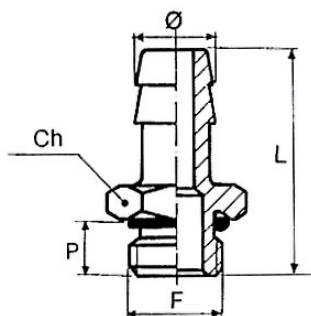

239.515

Einschraubschlauchtüllen, zylindrisch, mit O-Ring

Artikel-Nr.	Für Schlauch Ø mm	Gewinde F	Ch mm	P mm	L mm	O-Ring mm
239.501	LW 6	G 1/8	14	6,5	30,0	7,66x1,78
239.502	LW 8	G 1/8	15	6,0	31,0	7,66x1,78
239.503	LW 9	G 1/8	15	6,0	31,0	7,66x1,78
239.505	LW 6	G 1/4	17	8,0	32,0	10,82x1,78
239.507	LW 9	G 1/4	18	8,0	33,0	10,82x1,78
239.509	LW 12	G 1/4	18	8,0	33,0	10,82x1,78
239.510	LW 9	G 3/8	21	9,0	34,0	14,00x1,78
239.512	LW 12	G 3/8	21	9,0	34,0	14,00x1,78
239.515	LW 12	G 1/2	26	11,0	36,0	17,13x2,62

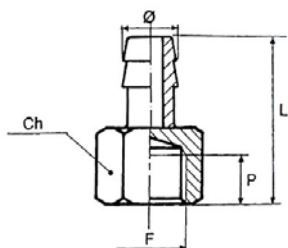

237.09-N

Aufschraubschlauchtüllen, Innengewinde zylindrisch

Artikel-Nr.	Für Schlauch Ø mm	Gewinde F	Ch mm	P mm	L mm
237.01-N	LW 6	G 1/8	12	8,5	28,0
237.02-N	LW 8	G 1/8	12	8,5	28,0
237.03-N	LW 9	G 1/8	12	8,5	28,0
237.04-N	LW 10	G 1/8	12	8,5	28,0
237.05-N	LW 6	G 1/4	15	10,0	33,0
237.06-N	LW 8	G 1/4	15	10,0	33,0
237.07-N	LW 9	G 1/4	15	10,0	33,0
237.08-N	LW 10	G 1/4	15	10,0	33,0
237.09-N	LW 12	G 1/4	15	10,0	33,0
237.10-N	LW 8	G 3/8	19	12,0	35,0
237.11-N	LW 10	G 3/8	19	12,0	35,0
237.12-N	LW 12	G 3/8	19	12,0	35,0
237.13-N	LW 14	G 3/8	19	12,0	35,0
237.14-N	LW 10	G 1/2	25	14,0	38,0
237.15-N	LW 12	G 1/2	25	14,0	41,0
237.16-N	LW 14	G 1/2	25	14,0	41,0

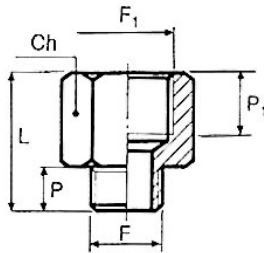

230.08-N

Verlängerungsstück, kurz, zylindrisch

Artikel-Nr.	Außen- gewinde F	Innen- gewinde F1	Ch mm	P mm	P1 mm	L mm
230.01-N	M5	G 1/8	12	4,0	7,0	17,0
230.02-N	G 1/8	G 1/8	14	6,0	7,0	18,5
230.03-N	G 1/8	G 1/4	17	6,0	8,0	21,5
230.04-N	G 1/4	G 1/4	17	8,0	8,0	22,5
230.05-N	G 1/4	G 3/8	22	8,0	10,0	26,0
230.06-N	G 3/8	G 3/8	22	9,0	10,0	26,5
230.07-N	G 3/8	G 1/2	24	9,0	11,0	29,5
230.08-N	G 1/2	G 1/2	25	10,0	11,0	29,5

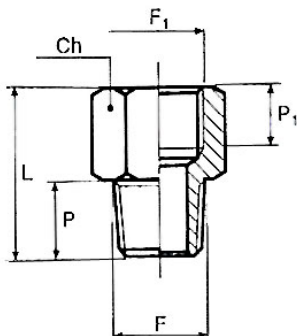

1230.10-N

Verlängerungsstück, kurz, Außengewinde konisch, Innengewinde zylindrisch

Artikel-Nr.	Außen- gewinde F	Innen- gewinde F1	Ch mm	P mm	P1 mm	L mm
1230.02-N	R 1/8	G 1/8	14	8,0	7,0	20,0
1230.03-N	R 1/8	G 1/4	17	8,0	8,0	22,5
1230.09-N	R 1/8	G 3/8	22	8,0	11,5	22,5
1230.04-N	R 1/4	G 1/4	17	11,0	8,0	25,0
1230.05-N	R 1/4	G 3/8	22	11,0	10,0	28,5
1230.06-N	R 1/4	G 1/2	24	11,0	14,0	29,0
1230.07-N	R 3/8	G 3/8	22	11,5	10,0	28,5
1230.08-N	R 3/8	G 1/2	24	11,5	11,0	32,0
1230.10-N	R 1/2	G 1/2	24	14,0	11,0	34,0
1230.11-N	R 1/2	G 3/4	32	14,0	16,5	35,0

Standardverschraubungen

Messing vernickelt
Artikel-Nr. 251.00/N bis 236.04-N

P 6-337

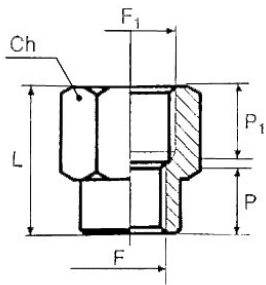

231.07-N

Verlängerungsstück, 2 x Innengewinde, zylindrisch

Artikel-Nr.	Gewinde F	Gewinde F1	Ch mm	P mm	P1 mm	L mm
231.01-N	M5	G 1/8	14	5,0	8,0	13,5
231.02-N	G 1/8	G 1/4	17	8,0	8,0	21,5
231.03-N	G 1/8	G 3/8	22	7,0	10,0	23,5
231.04-N	G 1/4	G 3/8	22	9,0	10,0	25,5
231.05-N	G 1/4	G 1/2	24	9,0	11,0	28,5
231.06-N	G 3/8	G 1/2	24	11,0	11,0	29,5
231.07-N	G 1/2	G 3/4	32	11,5	16,5	30,0

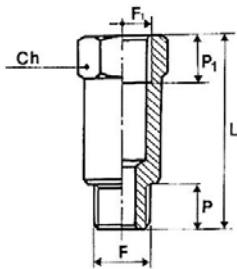

234.07-N

Verlängerungsstück, lang, zylindrisch

Artikel-Nr.	Außen- gewinde F	Innen- gewinde F1	Ch mm	P mm	L mm	P1 mm
234.01-N	G 1/8	G 1/8	14	6,0	22,0	8,0
234.02-N	G 1/8	G 1/8	14	6,0	42,0	8,0
234.03-N	G 1/8	G 1/8	14	6,0	51,0	6,0
234.04-N	G 1/8	G 1/8	14	6,0	100,0	8,0
234.05-N	G 1/4	G 1/4	17	8,0	35,0	11,0
234.06-N	G 1/4	G 1/4	17	8,0	51,0	11,0
234.07-N	G 1/4	G 1/4	17	8,0	100,0	11,0

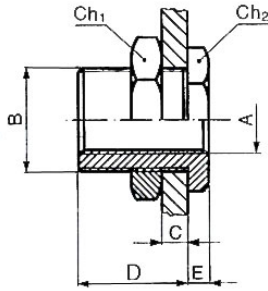

232.04-N

Schottverschraubung

Artikel-Nr.	Innen-gewinde A	Außen-gewinde B	C _{max}	D mm	E mm	Ch1 mm	Ch2 mm
232.01-N	G 1/8	M16x1,5	0	14,0	4,0	19	22
232.02-N	G 1/4	M20x1,5	0	21,0	5,0	27	24
232.03-N	G 3/8	M26x1,5	0	21,0	5,0	30	32
232.04-N	G 1/2	M28x1,5	0	27,0	6,5	36	32

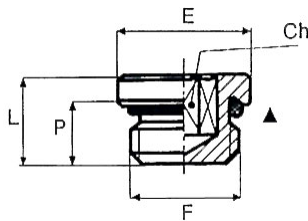

233.05-N

Verschlussstopfen, mit O-Ring

Artikel-Nr.	Gewinde F	Innen-Sechskant Ch mm	P mm	L mm	E mm	O-Ring mm	Max. Anzugs-drehmomente Nm
233.01-N	M5	2,5	4,0	6,5	8,0	3,5x1,2	1,2
233.02-N	1/8	3,0	7,0	9,5	15,0	7,66x1,78	2,5
233.03-N	1/4	6,0	8,0	11,0	18,0	10,82x1,78	8
233.04-N	3/8	8,0	9,0	12,5	21,0	14,00x1,78	10
233.05-N	1/2	10,0	11,0	14,5	26,0	17,13x2,62	15

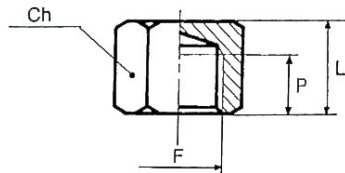

236.04-N

Verschlusskappen

Artikel-Nr.	Gewinde F	Ch mm	P mm	L mm
236.01-N	G 1/8	14	7,0	13,0
236.02-N	G 1/4	17	8,0	15,0
236.03-N	G 3/8	20	10,0	17,5
236.04-N	G 1/2	24	11,0	20,0